



EB Neuro, founded in 1998, is a leader in the instruments production in the neurology field and is able to provide complete solutions, both for the diagnostic and therapeutic.
EB Neuro continuously develops new solutions in the field of EEG/LTM, EMG/EP and TMS.

Reporting

The report generator, compatible with MS Office and Open Office, allows an unlimited number of templates and customizations and the import of all performed analysis.

HL7 integration

Galileo software can be connected to Hospital Network and HIS using HL7 communication protocols. Interfacing with HIS and other software platforms for the exchange of patient/data/report information and digital sign management.

Patient Management System

Galileo's Patient Management System (**PMS**) is an integrated DB manager, based on SQL engine. It grants the access to many important features from one single place. Access the patient history, start the backup, open a report, perform queries and statistics on custom defined codes and values and start post processing with third party products.

Database advanced security

An advanced security package completes the encryption of the information as a part of the GDPR (General Data Protection Regulation) requirements.



EB Neuro Academy, born from the social responsibility of the company, to support doctors, operators and managers is a constantly updated platform that guarantees information, support and training.

Per registrarsi: <http://www.ebneuro.com/en/academy>

EB Neuro S.p.A.
Via Pietro Fanfani, 97/A - 50127 Firenze Italy
Phone +39 055 4565111 Fax +39 055 4565123
ebneuro.com



BB330078001_MA Rev. A - BE PLUS PRO in inglese



Neurology excellence, Neurology evolution



BE PLUS PRO FAMILY
EEG/vEEG solutions

HARDWARE



TOUCHSCREEN
Navigation without keyboard and mouse

EXTENDED FLEXIBILITY
Medical grade 24" PC with battery

ADJUSTABLE SPINE
with frontal basket

SMALL FOOTPRINT
Easy to roll between rooms

BE PLUS PRO

is a powerful and versatile amplifier, offering high quality signal which is available in a variety of configurations to suit different applications, from Routine EEG to Evoked Potentials and Research.

System Key Features

- 24-bit AD conversion
- High Sampling Rate, up to 32 KHz
- Possibility to use all Channels in AC/DC
- Synchronized Full HD Video (1920x1080)
- LCD color display for impedance checks and signals visualization
- Start recording from amplifier control console without the PC
- Integrated event button
- Multiple connection modes: wired, wireless and ambulatory

SOFTWARE



Galileo NExT – EEG.NET

is an intuitive and flexible software that simplifies the process of collecting, monitoring, trending and managing data for routine EEG, long-term monitoring (LTM), ambulatory, and research studies.

System Key Features

- Role-based security for HIPAA and GDPR compliance
- Configurable automatic data archiving
- SQL Server database
- Remoting vEEG monitoring
- IP streaming Full HD cameras and amplifiers
- Variety of analysis tools: frequency analysis, advanced trending and Persyst
- Bi-directional HL7 integration with HIS/EMR
- LSL or SDK for direct EEG data access for research

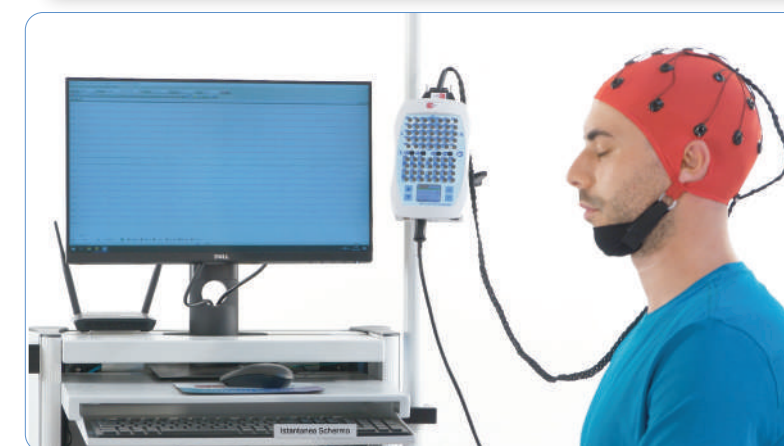

BE PLUS PRO can be used with different connection modes (wired, wireless or ambulatory recording) guaranteeing the integrity and quality of the acquired data thanks to Galileo software and to Zero Data Loss (ZDL) mode.

ZERO DATA LOSS

UNIQUE METHOD OF OPERATION FOR DATA SAFETY

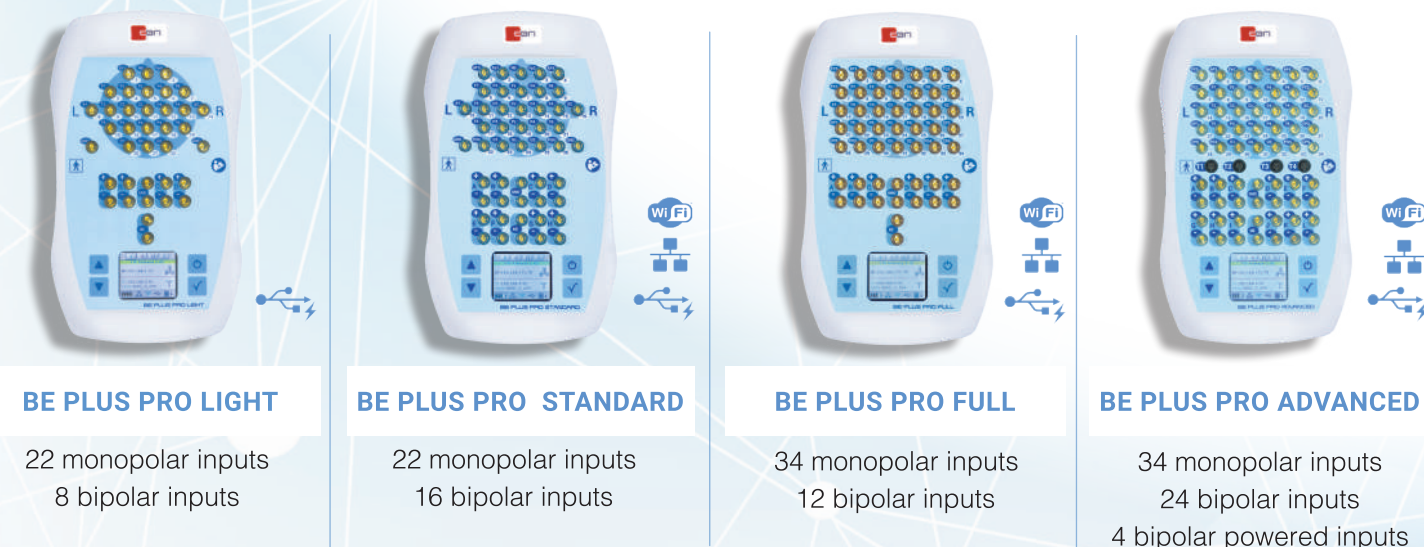
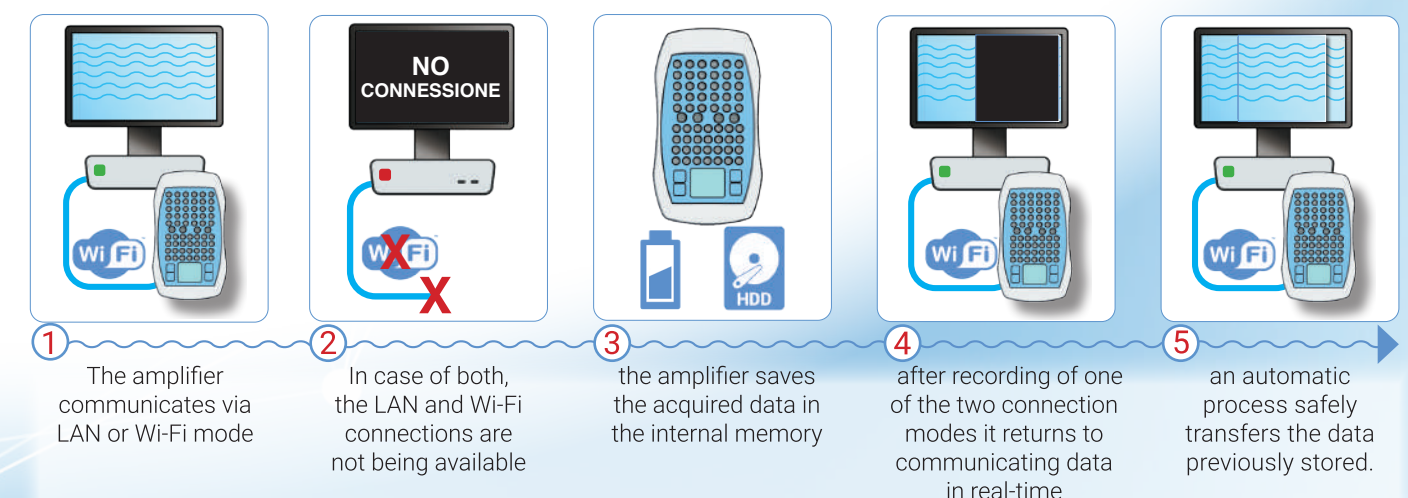

BE PLUS PRO LIGHT

22 monopolar inputs
8 bipolar inputs

BE PLUS PRO STANDARD

22 monopolar inputs
16 bipolar inputs

BE PLUS PRO FULL

34 monopolar inputs
12 bipolar inputs

BE PLUS PRO ADVANCED

34 monopolar inputs
24 bipolar inputs
4 bipolar powered inputs